

ASSEMBLY INSTRUCTIONS

Action Wholesale Products

Model numbers: K78 and K7824

(Refer to Figure 1 and Door Lock Detail)

Do not tighten bolts until cabinet is completely assembled.

Tools required: Rubber mallet, slotted screwdriver, 11/32" wrench (11/32" socket may be substituted).

1200 Edinger Avenue
Tustin, California 92780
1-800-966-3999
(714)247-0100

ALL MODELS

1. Place back (Ref. No. 1) on either padded horses or on protected floor so the flange is upward.
2. Attach sides (Ref. Nos. 2 & 3) to back by placing side with flange around back and bolting together with slotless #8-32 x 3/8" bolts and nuts. Be certain that all shelf adjustment strips are pointed in the same direction.
3. Place a shelf (Ref. No. 7) into shelf adjustment strips to hold sides in upright position. Be sure channeled edge of shelf is to the front.
4. Locate top which has the holes along the perimeter (Ref. No. 4). Place top, with two holes toward front, under flanges at top of sides and back. Bolt together.
5. Place door and frame assembly (Ref. No. 6) over body.
6. Bolt sides to frame.
7. Place bottom (Ref. No. 5) in lowest notch of shelf adjusting strips on sides and back so that the flange with two holes faces the front and is over the flange of frame sill. Push out on side wall to enable bottom to more easily slide into position.
8. Bolt bottom to frame sill.
9. Using a rubber mallet, place adjustable shelves in desired position with channeled edge toward front and press end and back flanges into notches of shelf adjusting strips.
10. Stand unit upright.
11. Tighten all hardware.
12. Install locking mechanism as follows (Refer to Door Lock Detail):
 - a. Place locking handle (Ref. No. 13) on right hand door and fasten with #8-32 bolts with lockwashers.
 - b. Turn handle to open position and place locking cam (Ref. No. 14) over square shank of door handle with latch facing downward.
 - c. Hook locking bars (Ref. No. 12) to locking cam and hold in position while sliding nylon lock bar guide inserts (Ref. No. 16) over door lock bar and through door slots.
 - d. Place locking cam retainer (Ref. No. 15) over square shank of door handle and drive into place.

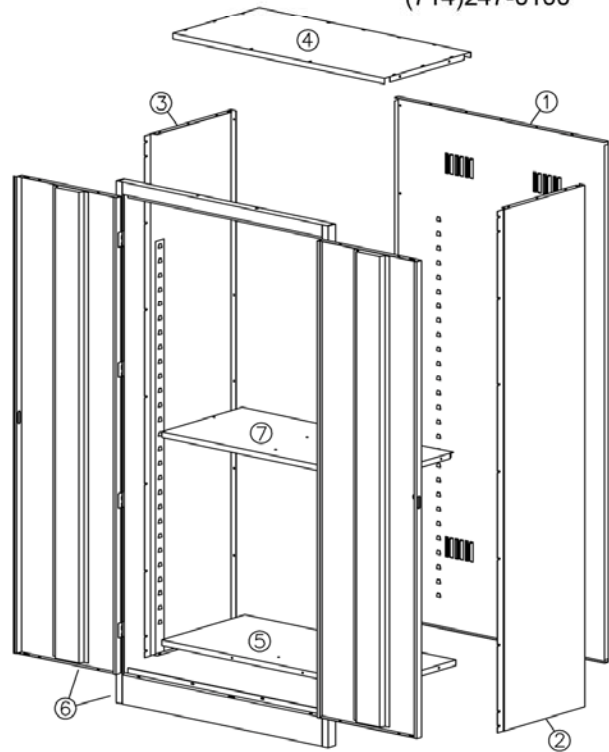
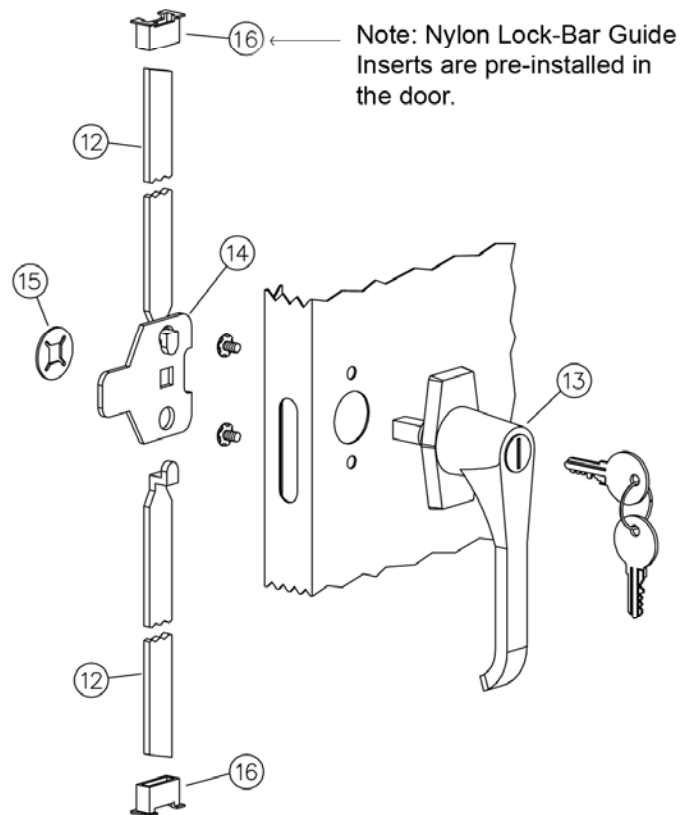

Figure 1:



Door Lock Detail